

Cellular & Pleated Shades

MOTORIZED SHADE

Simplicity



Installation & Care Instructions

152142 F
3/2/2016

GETTING STARTED

A few simple tools are required:

- Measuring tape
- Power drill, drill bits
- 1/4" Hex head and/or Phillips driver bit
- Pencil

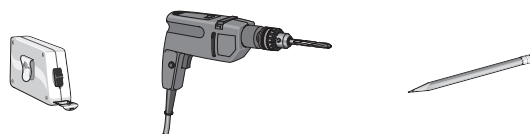

Additional fasteners other than those sent with your shade may be required depending on the mounting surface. Wallboard and plaster require the use of anchors such as expansion or toggle bolts. Brick, tile or stone need special plugs and drill bits. Remember to always pre-drill holes in wood to avoid splitting.

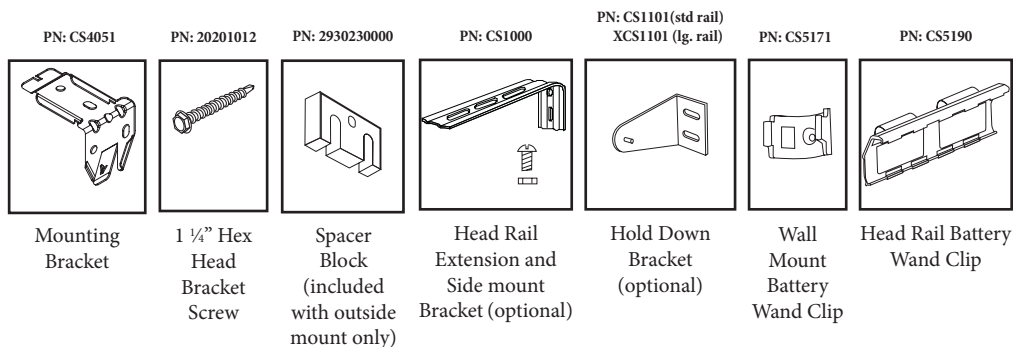

STEP 1: BRACKET INSTALLATION

Shades are shipped with the required number of brackets for proper installation. End brackets should be located approximately 3" from either end. Depending on the width of the shade, additional brackets may be necessary, evenly spaced between the two end brackets. **If mounting the battery wand to the head rail, bracket positions may need to be adjusted to accommodate the battery wand. You must have at least 19" between bracket centerlines to fit the battery wand.**

Using the installation bracket as a template, measure to the edge of the bracket and mark the hole locations with a pencil for drilling.

Brackets must be in line and level. Shim brackets on inside mounts if necessary. The head rail must be level for the shade to operate properly.

Important: Spacer blocks are required on outside mount shades using the head rail battery wand clip.

Shade Width	# of Brackets
Up to 40"	2
>40" - 72"	3
>72" - 84"	4
>84" and up	5

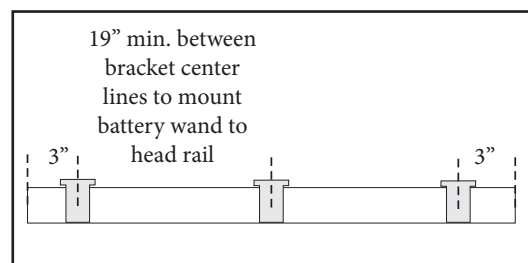
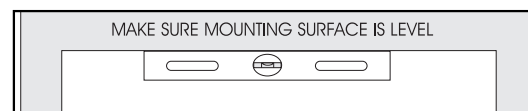

INSIDE MOUNT

The minimum mounting depth for an inside mount is $\frac{1}{2}$ " for wall mounted battery wand and $1\frac{1}{4}$ " for head rail mounted wand.

A minimum of $2\frac{1}{4}$ " is needed to fully recess the shade if wall mounting the battery wand. A minimum of 3" is needed to fully recess the shade if mounting the battery wand to the head rail.

Make sure that the brackets are level and aligned.

Attach using two screws when possible. One screw is sufficient on shallow mounts.

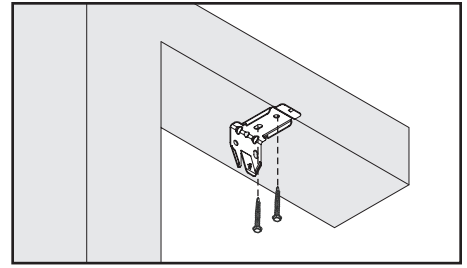

Inside Mount

Shallow Mount - Minimum $\frac{1}{2}$ " surface

Flush Mount - Minimum $2\frac{1}{4}$ " surface

OUTSIDE MOUNT

The minimum mounting height for outside mounted shades is $\frac{7}{8}$ ".

Make sure that the brackets are level and aligned.

Attach using two screws.

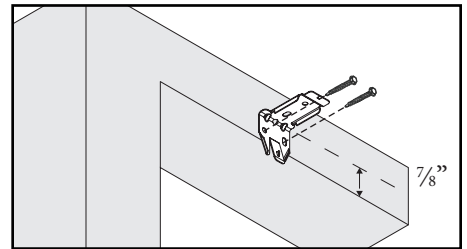

Outside Mount

Minimum $\frac{7}{8}$ " surface

OUTSIDE MOUNT FOR HEAD RAIL MOUNTED BATTERY WAND

Two spacer blocks must be stacked to give enough clearance for the battery wand.

Make sure that the brackets are level and aligned.

Attach using the screws that were provided in the package with the spacers. Screws should be long enough to secure the bracket to the mounting surface.

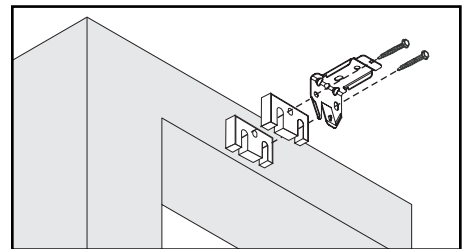

Outside Mount for Head Rail Mounted Battery Wand

SPACER BLOCKS (OPTIONAL)

Each spacer block projects brackets $\frac{1}{2}$ " away from mounting surface.

Make sure that the brackets are level and aligned.

Attach using two screws. Screws should be long enough to secure the bracket to the mounting surface.

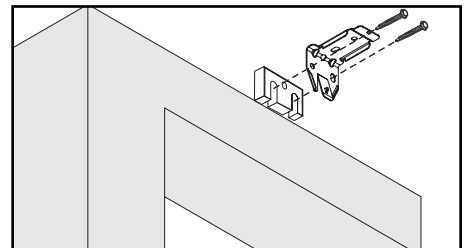

Outside Mount with Spacer Blocks

EXTENSION BRACKETS (OPTIONAL)

Optional extension brackets are used to project the back of the shade up to $2\frac{3}{8}$ " from the mounting surface.

Attach the mounting bracket to the extension bracket with the nut and bolt provided.

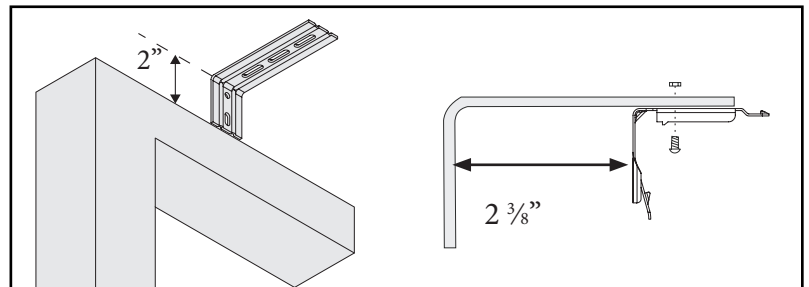

Outside Mount with Extension Brackets

Minimum $2\frac{3}{8}$ " surface

SIDE MOUNT (OPTIONAL)

Measure from window sill up to desired mounting position on each side of the window frame. Mark position.

Mount side mount brackets on each side of window frame as shown. Make sure to confirm that head rail will sit perfectly level.

Once side mount brackets are installed and properly positioned, attach the mounting brackets using the nuts and bolts provided.

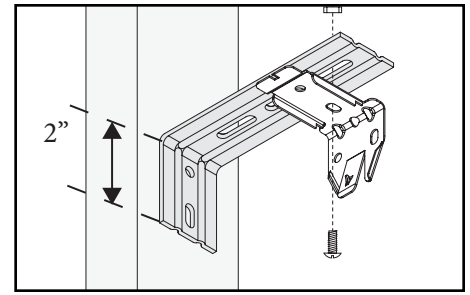

Side Mount
Minimum 2" surface

STEP 2: INSTALL BATTERY WAND (IF USING TRANSFORMER, SKIP TO STEP 3)

WALL MOUNT

Attach the wand clips in the desired location with the screws provided. Before mounting the wand, make sure that the wand and excess wire will not interfere with the operation of the shade. Extension wires are available if needed.

Press the wand into the clips.

Please Note: Be sure battery wire will reach motor plug.

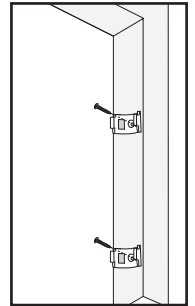

HEAD RAIL MOUNT

Attach the wand clips to the back of the head rail as shown. **Important:** Position the clip so that the battery wand will be between mounting brackets.

Before mounting the wand, make sure that the wand and excess wire will not interfere with the operation of the shade. Extension wires are available if needed.

Press the wand into the clip.

Please Note: Be sure battery wire will reach motor plug.

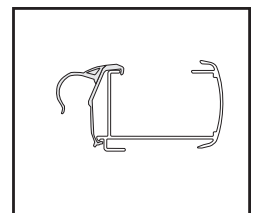
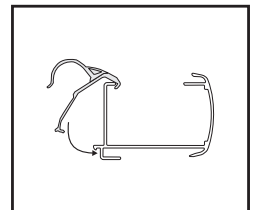

STEP 3: SHADE INSTALLATION

Before mounting the head rail make sure that the receiver wire is out of the head rail. For optimal performance, position the receiver wire so that it is facing into the room.

Position the motor wire so that it comes out the back side of the shade.

Position the head rail with the front lip (A) resting on the top hooks of all the brackets.

While holding the fabric out of the way, push the bottom of the head rail upward and toward the window until the groove at the bottom of the head rail snaps into place, (B) as shown.

Make sure that no fabric is pinched between the brackets and the head rail.

Be sure the motor wire is not pinched by the bracket.

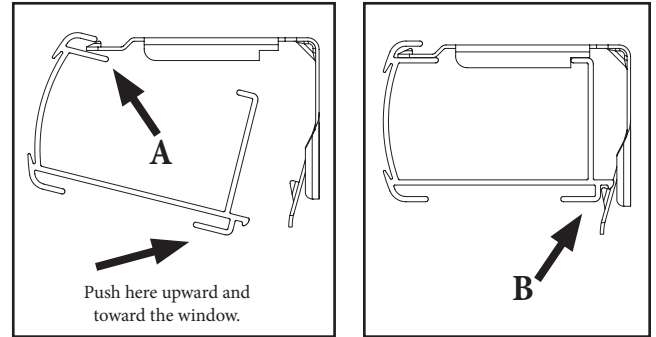

STEP 4: CONNECT POWER SOURCE - BATTERY WAND/TRANSFORMER

BATTERY WAND

Plug the battery wand wire into the motor wire.

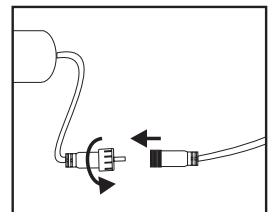

TRANSFORMER (OPTIONAL)

Plug the transformer wire into the motor wire. Secure the wire behind the shade and along the window casing as required.

Plug the transformer into an electrical outlet.

If the wire is not long enough to reach, optional 48" extension wires are available.

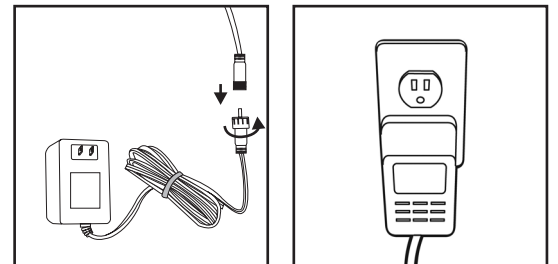

OPERATION

The factory has set your shade to the channel that was specified at the time of order. If no channel was specified, the shade was set to operate on channel 1 and “all”.

Select the desired channel with the **CHANNEL** buttons. The channel indicator light will illuminate the channel that is on. If all 5 lights are lit the remote will control all 5 channels at once.

Tapping the **UP** or **DOWN** buttons for less than 2 seconds will move the shade in short steps. Holding the **UP** or **DOWN** buttons down for more than 2 seconds before releasing will operate the shade in the faster standard speed.

Press the **UP** or **DOWN** buttons to raise or lower the shade.

Press the **STOP** button to stop the shade anywhere along the travel.

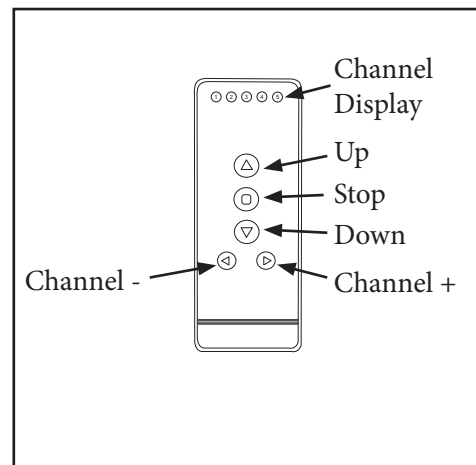

SETTING AND USING A FAVORITE POSITION

Use the **UP** or **DOWN** buttons to position the shade at the desired “favorite” position. First press and hold the **LIMIT** button on the back of the remote with a small screwdriver or tip of a pen. While holding the **LIMIT** button press and hold the **UP** button. Release both buttons when the shade jogs.

With the shade at either the upper or lower limit, simply press the **STOP** button to bring the shade to the “favorite” position. To go to the “favorite” position from any other location, make sure the shade has been stopped for at least three seconds before pressing the **STOP** button.

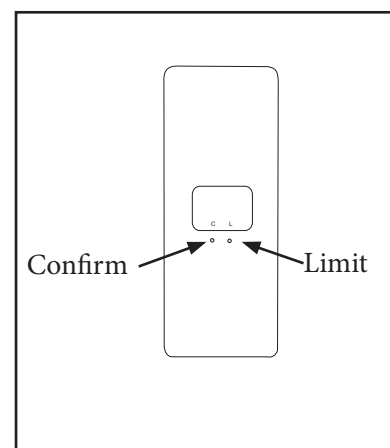

LEVEL THE BOTTOM RAIL (IF NECESSARY)

Cellular shades use a system that allows easy leveling of the bottom rail. It is designed to make slight adjustments (less than 1”) to level the bottom rail of your shade. It is not designed to make length adjustments.

Use a flat head screwdriver or a coin (a quarter works best) to turn the adjustment screw to raise or lower that side of the bottom rail. The adjustment screw is on the underside of the bottom rail.

One quarter turn of the screw will move the bottom rail up or down approximately $\frac{1}{4}$ ”.

Over-turning the adjustment screw (more than 1” of adjustment) can cause the cord to tangle or wedge inside the rail. The screw should turn easily - DO NOT FORCE.

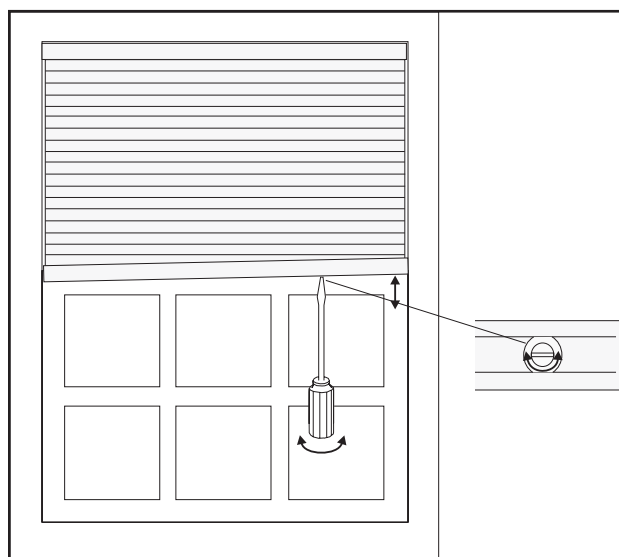

ADJUST MOTOR LIMITS ON PRIMARY REMOTE (IF DESIRED)

The lower and upper limits have been set at the factory. If you need to make adjustments to the limits, follow the instructions below.

Please Note: When clearing the factory set limits, both the upper and lower limits will need to be reset.

Use the **CHANNEL** button to select the channel for the shade that needs to be adjusted. Then follow the directions below. If only adjusting one shade on a channel, unplug the other shades.

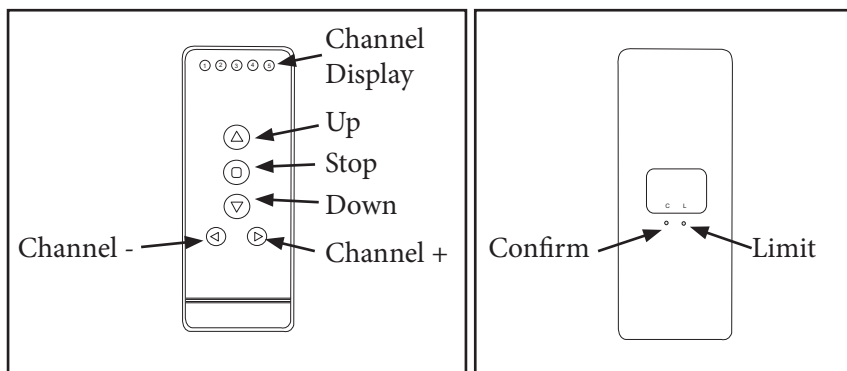

A. Set Lower Limit

	OPERATION	RESULT
1	Hold LIMIT button down	The motor begins to jog
2	Release the button after jogging starts	The motor is ready for limit setting
3	Press DOWN button	The motor will go down continuously
4	When the motor is close to the desired lower limit, press STOP button on the remote	The motor stops running
5	Press either the UP or DOWN button	The motor runs step by step to adjust lower limit accurately
6	Confirm the setting by pressing the CONFIRM button on the remote	The motor jogs and the lower setting is completed

B. Set Upper Limit

	OPERATION	RESULT
1	Press UP button on the remote transmitter	The motor will go up continuously
2	When the motor is close to the desired upper limit, press STOP button on the remote	The motor stops running
3	Press either the UP or DOWN button	The motor runs step by step to adjust upper limit accurately
4	Confirm the setting by pressing the CONFIRM button on the remote	The motor jogs and the upper setting is completed

CHANGE FAVORITE POSITION (IF ONE WAS SET)

Use the **UP** or **DOWN** buttons to position the shade at the desired “favorite” position. First press and hold the **LIMIT** button on the back of the remote with a small screwdriver or tip of a pen. While holding the **LIMIT** button press and hold the **UP** button. Release both buttons when the shade jogs.

To erase the “favorite” position bring the shade to the **upper** limit. Press and hold the **LIMIT** button on the back of the remote, then press and hold the **UP** button. Release both buttons when the shade jogs.

ADVANCED PROGRAMMING

REPLACE ORIGINAL REMOTE OR ADD ADDITIONAL REMOTE

1. Remove the shade from the window. Press the **SETTING** button on the motor until the shade jogs once. Release the button immediately after the first jog - this should be not more than 3 seconds.
2. Repeat this step for all shades that will be controlled by a single channel.
3. Select the channel that you want to program using the **CHANNEL** selector button.
4. Press and hold the **CONFIRM** button until the shade(s) jogs once. The shade will now operate when the channel is selected.
5. Repeat steps 1-4 to program the rest of the channels on a multi-channel remote.
6. To set the All function on the multi-channel remote, activate the setting buttons (step 1) on all shades. Press the Channel button until all indicator lights are lit and then press confirm.

Please Note: You will not be able to adjust the lower or upper limits with the secondary remote or a secondary channel (if one shade is programmed to multiple channels). If the original remote was lost and the limits need to be reset, follow the instructions in the next section.

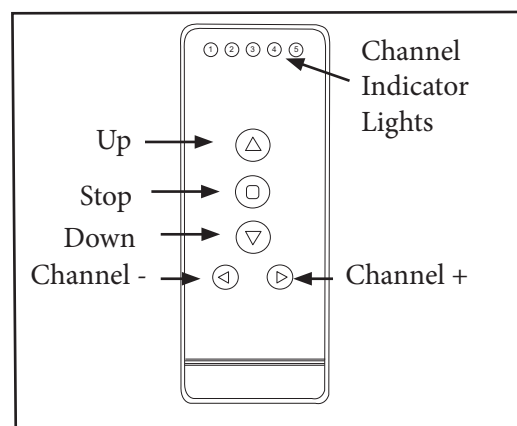
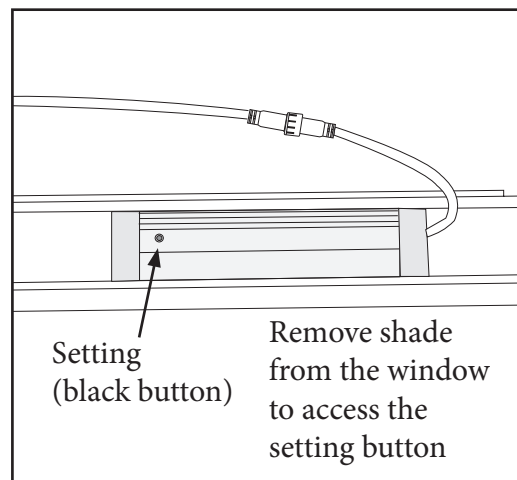

REMOVE A SHADE FROM A REMOTE OR CHANNEL AND LINK IT TO A DIFFERENT REMOTE OR CHANNEL

Unlink the motor from the remote

Note: this step also erases the lower and upper limits.

1. Remove the shade from the window. Press and hold the **SETTING** button for 1 cycle of jog/jog jog. Release after the 1st cycle.
2. Release the **SETTING** button. The original remote or channels have been unlinked.

Link the motor to the new remote or channel

1. Follow the steps for replacing the remote above.
2. Set the lower and upper limits by following the instructions on page 8.

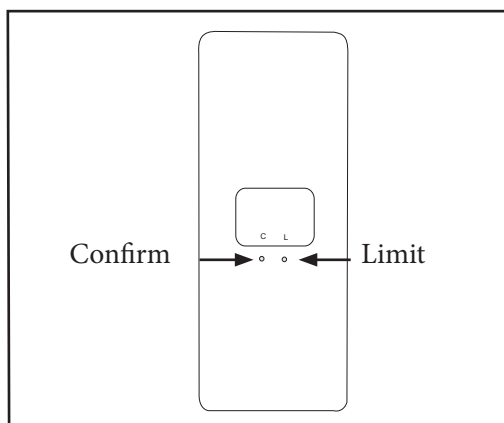

HOLD DOWN BRACKETS (OPTIONAL)

Optional hold down brackets are mounted with the supplied screws.

With the shade at its proper drop, place the pin of each hold down into the hole in each end cap and mark the screw holes. Make sure the pins are level and aligned.

Raise the shade, then screw the hold down bracket into the mounting surface. Slightly flex the hold down brackets to insert the pins into the endcaps.

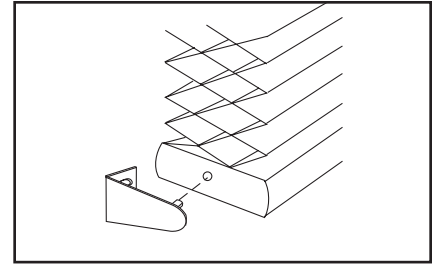

Hold Down Bracket

REMOVING THE SHADE

If you need to remove your shade, follow the instructions below.

To remove a shade, insert a screwdriver between the head rail and the bottom back of the bracket (tab which extends out slightly from each bracket).

Gently pry the screwdriver to release the bracket from the head rail. Take care not to damage the painted finish of the head rail.

As you release the brackets, support the head rail to keep it from falling.

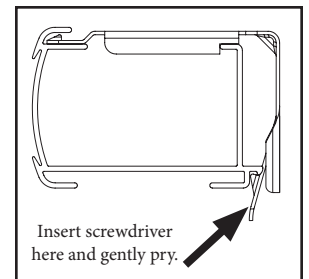

CLEANING AND CARE

The shade fabric is easy to care for. Regular dusting with a feather duster or vacuum cleaner brush is recommended. Most stains can be blotted with a damp sponge and mild detergent. Before using anything stronger than mild detergent and lukewarm water, test an unobtrusive corner of the shade. If you have any questions, call your dealer for advice.

TROUBLE SHOOTING

PROBLEM	SOLUTION
The motor does not work.	<ol style="list-style-type: none"> 1. Check that the power source and motor are connected properly. 2. If using a battery wand - confirm that the batteries are fresh and are placed in the wand in the correct orientation.
The motor continues to run in one direction.	The limit setting was unsuccessful and needs to be reset.
The indicator light on the remote does not shine or the remote-controlling range becomes shorter.	Replace the battery in the remote (CR2430 lithium).
The motor stops working or works intermittently.	If using a battery wand, replace the batteries in the wand with 8 fresh AA alkaline batteries.

REPLACING THE BATTERY IN THE REMOTE

Remove the battery tray from the remote by inserting a fingernail into the indentation on the back of the remote. To avoid the battery falling out of the remote, remove the tray while the remote is face up.

Insert the new battery (CR2430 lithium) into the battery tray so that the writing is facing up when the remote is face up. Slide the tray back into the remote.

